



2-in-1 Slide to Rocker

INSTRUCTION MANUAL

No. 2024-03
Ages: 1½ - 3y
GB

DO NOT DISCARD: IMPORTANT LITERATURE. KEEP THESE INSTRUCTIONS FOR FUTURE REFERENCE. OBSERVE ALL SAFETY WARNINGS AND CAUTIONARY STATEMENTS TO REDUCE THE RISK OF SERIOUS OR FATAL INJURY.

WARNING: Only for domestic use. **TO AVOID SERIOUS INJURY:** DO NOT install this product on a hard surface. Any fall onto a hard surface could result in a head or other serious injury. Never place on concrete, asphalt, wood, packed earth or other hard surfaces. Carpeting over a hard floor may not prevent an injury.

SAFETY INSTRUCTIONS

FALL HAZARD - Never use this product on any elevated surface, since child's movement may cause the product to slide or tip over. Use only on a floor.

CHOKING HAZARD - Small parts. This product contains small parts and sharp points which are necessary for assembly. Prior to or during assembly of this product, keep all components out of children's reach. Small parts pose a choking hazard to children under 3 years of age.

- This product is designed for normal residential use only, and is not intended for use in schools, parks, day care centers, nurseries, or other public places.
- Adult assembly required. Phillips / cross-headed screwdriver (not included) required during assembly.
- Place this product on level ground not less than 6 feet (1.8 m) away from any structures or obstructions such as trees, fences, garages, houses, sheds, hedges, overhanging branches, laundry lines or electrical wires.
- On-site adult supervision is required for children of all ages at all times when on or around this product. Never leave children unattended.
- Slide feet first. One (1) child at a time.
- This product is intended for use by children ages 1½ - 3 years.
- Maximum weight limit: 50 lbs (23 kg). Limit 1 child at any one time.

CAUTION: Observing the following statements and warnings to reduce the likelihood of serious or fatal injury.

- DO NOT allow children to play on this product until it is completely installed.
- DO NOT allow children to stand, walk close to, behind, in front of, or between moving product. Instruct children to keep a safe distance away.
- DO NOT let children use this product in any manner other than intended.
- DO NOT allow children to stand on the rocker / slide.
- Warn children not to get off the product while it is in motion.
- Dress children appropriately while on and around this product. Use well-fitting shoes that do not have slippery soles. DO NOT allow children to wear ponchos, scarves, hoods, jewelry, loose shoes, loose-fitting clothing, neckties, clothing with loose strings and/or clothing that might be potentially hazardous while using this product.
- Instruct children to remove their bike or other sports helmet before using this product.
- Make sure all parts are securely snapped together before use.

PARTS

Notes: Illustrations not to scale.

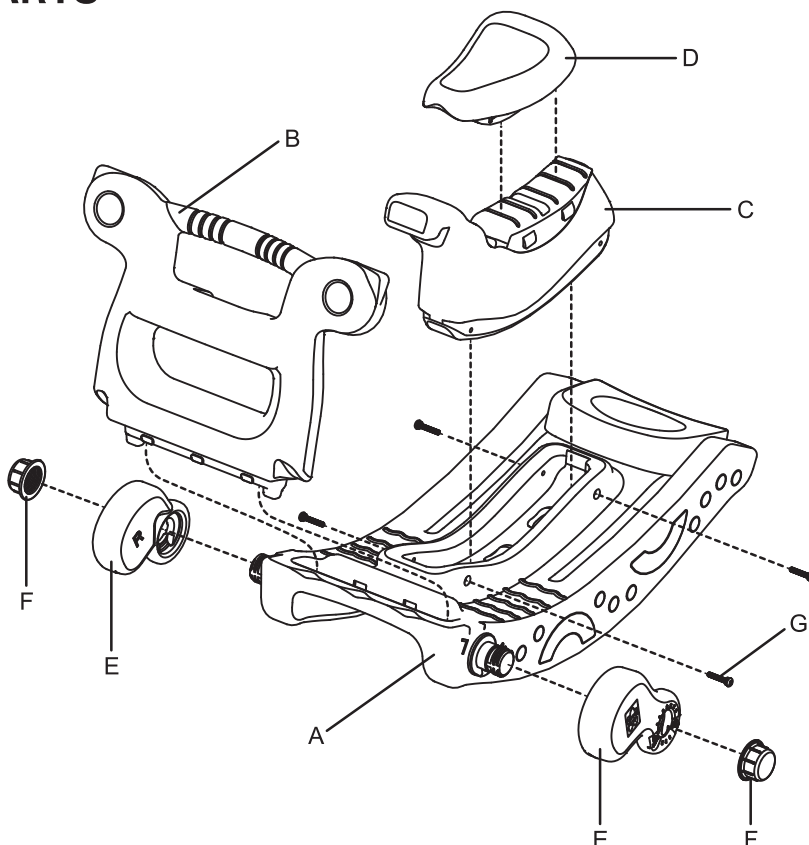

PARTS LIST

#	DESCRIPTION	QTY
A	Rocker / Slide	1
B	Ladder	1
C	Body	1
D	Seat	1
E	Stopper / Handle (L / R)	2
F	Screw Cap	2
G	Metal Screw	4

FASTENER SHOWN ACTUAL SIZE



G - Metal Screw x 1.38 inch / 35 mm
x 4

ASSEMBLY INSTRUCTIONS

- 1**
- Turn the Rocker / Slide (A) upside-down, with the Rocker bed **FACING UP**.
 - Join the Ladder (B) into the Rocker front. Press downwards until the edges are flush.

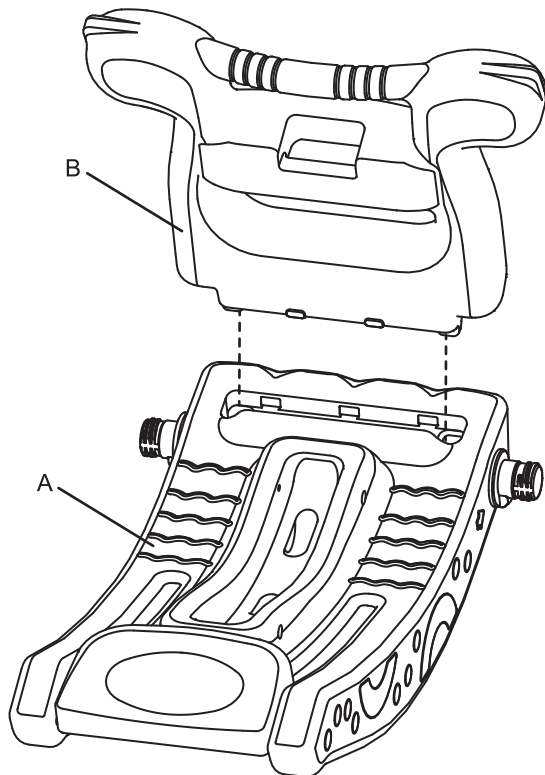

- 2**
- Place the Body (C) onto the Rocker.
 - Make sure the front hook is attached to the middle step of the Ladder as shown.

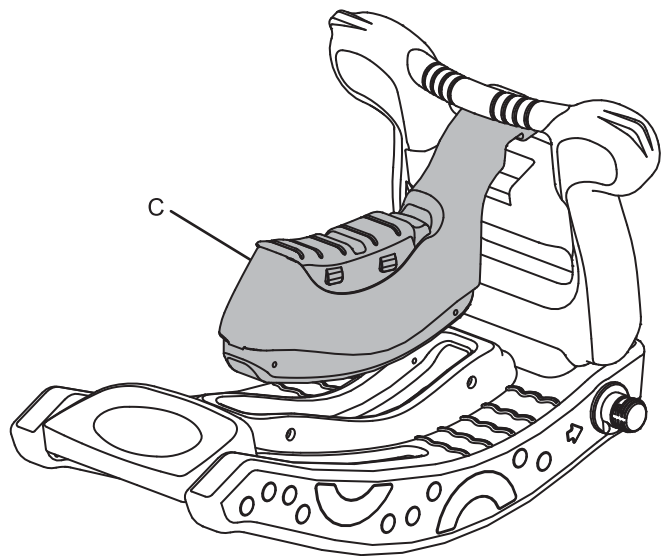

- 4**
- Fasten 2 Screws (G) with a Phillips headed screwdriver (not included) to each side base of the body. Total of 4 Screws are needed.

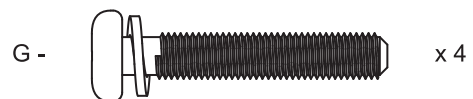
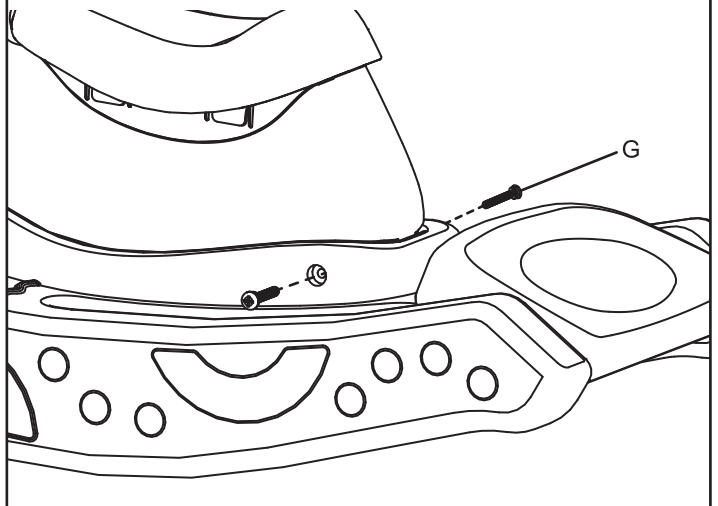

- 3**
- Attach the Seat (D) over the body.

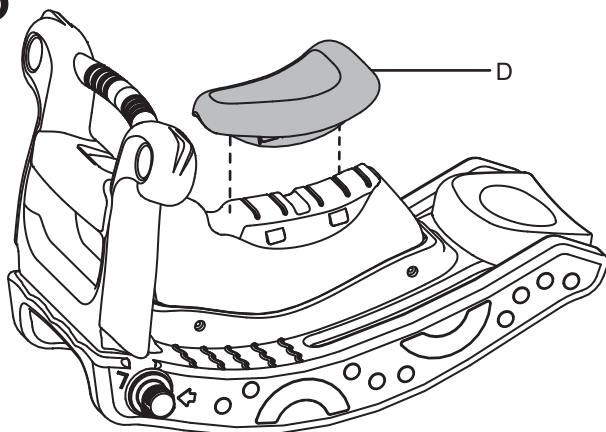

- 5**
- Attach the Rocker Stoppers (Slide Handles) at the side tabs of the Rocker as shown.
 - Hand thread the Screw Cap (F) to lock each tab end.

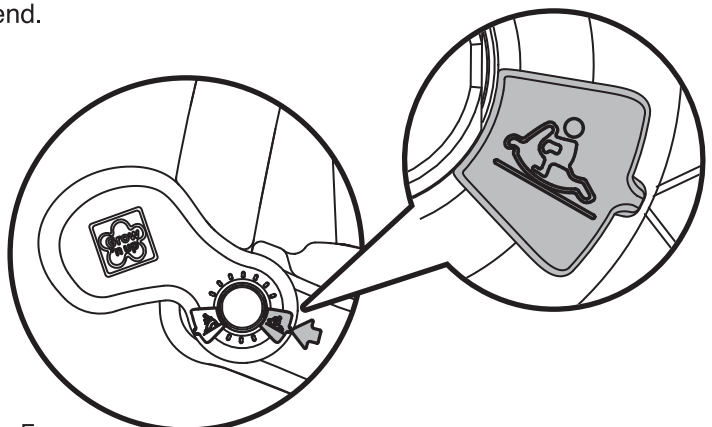
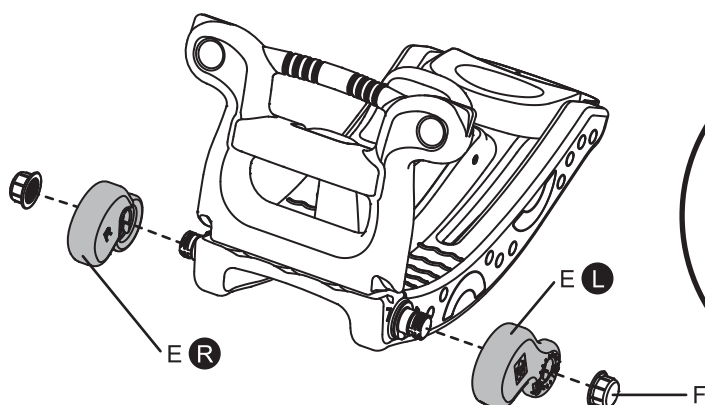

- 6** Picture shows the final assembled **ROCKER**.
⚠ Make sure the Rear Yellow Extension is **FOLDED DOWN**.

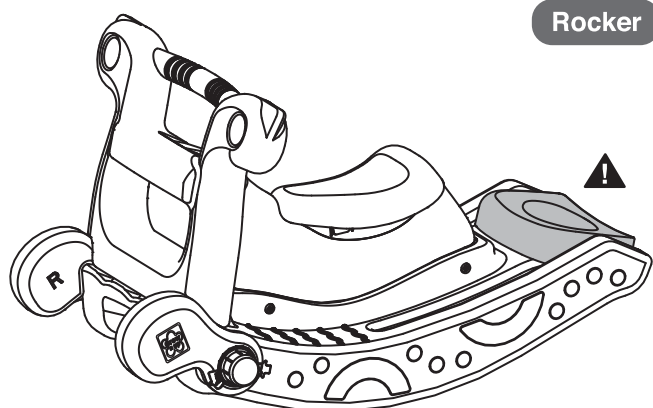

Rocker

- 8**
- Turn the Rocker upside-down.
 - Loose the Screw Cap and turn the Rocker Stopper to its upright position for changing it into the Slide Handle.
 - Return and fasten the Screw Cap securely.
 - Repeat this for the other side.

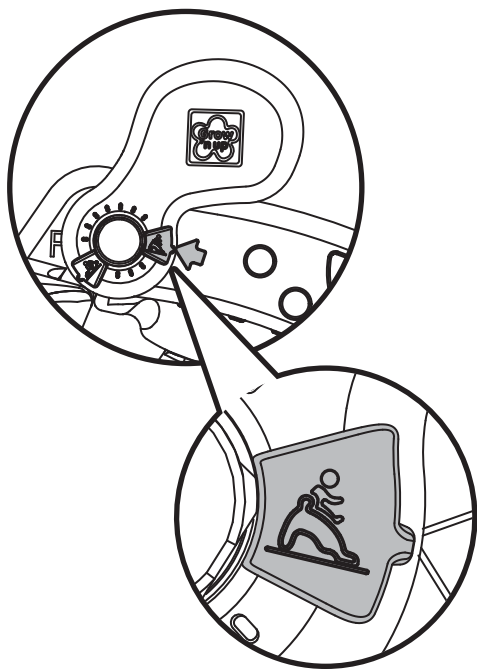
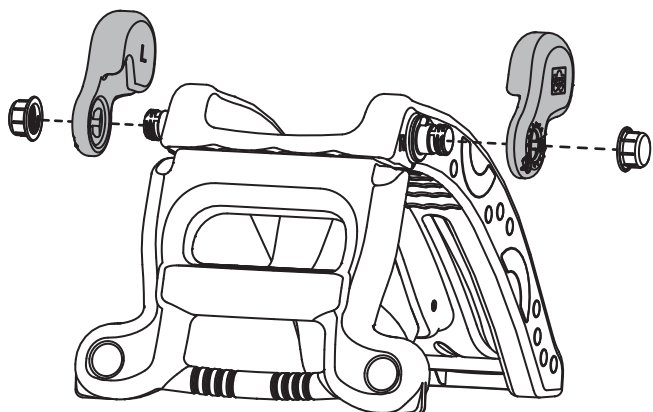

- 7** To convert Rocker into a **SLIDE**: swing open the Rear Yellow Extension.

⚠ CAUTION: Transition from Rocker to Slide must be conducted by an adult.

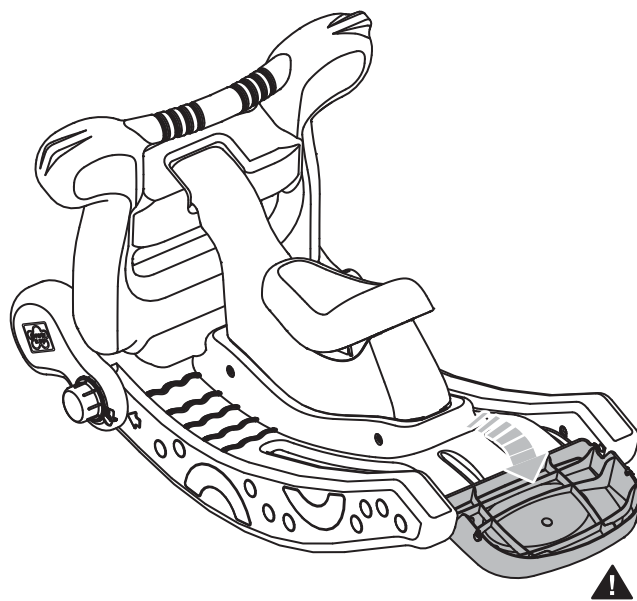

- 9** Picture shows the final assembled **SLIDE**.

Slide

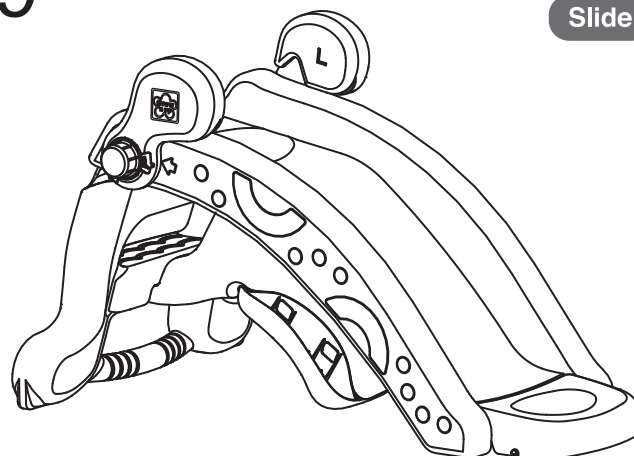

CONSUMER INFORMATION

Information on Playground surfacing materials:

Maximum fall height for this product is 19.7 inch / 500 mm.

Select Protective Surfacing—One of the most important things you can do to reduce the likelihood of serious head injuries is to install shock-absorbing protective surfacing under and around your play equipment. The protective surfacing should be applied to a depth that is suitable for the equipment height in accordance with ASTM Specification F 1292. There are different types of surfacing to choose from; whichever product you select, follow these guidelines:

Loose-Fill Materials:

Maintain a minimum depth of 9 inches of loose fill materials such as wood mulch/chips, engineered wood fiber (EWF), or shredded/recycled rubber mulch for equipment up to 8 feet high; and 9 inches of sand or pea gravel for equipment up to 5 feet high. **NOTE:** An initial fill level of 12 inches will compress to about a 9 inch depth of surfacing over time. The surfacing will also compact, displace, and settle, and should be periodically refilled to maintain at least a 9 inch depth.

Use a minimum of 6 inches of protective surfacing for play equipment less than 4 feet in height. If maintained properly, this should be adequate. (At depths less than 6 inches, the protective material is too easily displaced or compacted.)

NOTE: Do not install home playground equipment over concrete, asphalt, or any other hard surface. A fall onto a hard surface can result in serious injury to the equipment user. Grass and dirt are not considered protective surfacing because wear and environmental factors can reduce their shock absorbing effectiveness. Carpeting and thin mats are generally not adequate protective surfacing. Ground level equipment – such as a sandbox, activity wall, playhouse or other equipment that has no elevated play surface – does not need any protective surfacing.

Use containment, such as digging out around the perimeter and/or lining the perimeter with landscape edging. Don't forget to account for water drainage.

Check and maintain the depth of the loose-fill surfacing material. To maintain the right amount of loose-fill materials, mark the correct level on play equipment support posts. That way you can easily see when to replenish and/or redistribute the surfacing.

Do not install loose-fill surfacing over hard surfaces such as concrete or asphalt.

Poured-In-Place Surfaces or Pre-Manufactured Rubber Tiles—You may be interested in using surfacing other than loose-fill materials – like rubber tiles or poured-in-place surfaces.

Installations of these surfaces generally require a professional and are not “do-it-yourself” projects.

Review surface specifications before purchasing this type of surfacing. Ask the installer/manufacture for a report showing that the product has been tested to the following safety standard: ASTM F1292 Standard Specification for Impact Attenuation of Surfacing Materials within the Use Zone of Playground Equipment. This report should show the specific height for which the surface is intended to protect against serious head injury. This height should be equal to or greater than the fall height – vertical distance between a designated play surface (elevated surface for standing, sitting, or climbing) and the protective surfacing below – of your play equipment.

Check the protective surfacing frequently for wear.

Placement—Proper placement and maintenance of protective surfacing is essential. Be sure to:

Extend surfacing at least 6 feet from the equipment in all directions.

For to-fro swings, extend protective surfacing in front of and behind the swing to a distance equal to twice the height of the top bar from which the swing is suspended.

For tire swings, extend surfacing in a circle whose radius is equal to the height of the suspending chain or rope, plus 6 feet in all directions.

¹This information has been extracted from the CPSC publications “Playground Surfacing—Technical Information Guide” and “Handbook for Public Playground Safety.” Copies of these documents can be obtained by sending a postcard to the: Office of Public Affairs, U.S. Consumer Product Safety Commission, Washington, DC 20207 or by calling the toll free hotline: 1-800-638-2772.

CARE AND MAINTENANCE

Check all hardware twice monthly during the usage season for tightness, and tighten as required. It is particularly important that this procedure be followed at the beginning of each season.

- At the beginning of each play season: Rake and check depth of loose fill protective surfacing materials to prevent compaction and to maintain appropriate depth. Replace as necessary.
- Check all bolts, edges and corners of the unit at the beginning of the usage season and monthly thereafter for evidence of deterioration and damage. If not checked on a regular basis, parts can be loosen, cracked or be misplaced and components may detach and cause an injury. Immediately remove and replace any items that appear to be weak or broken. Contact Customer Service (page 4) for replacement parts.
- Check metal parts for rust. If found, sand and repaint using a nonlead-based paint meeting the requirements of 16 CRF 1303.
- DO NOT allow children to climb or to play when the surface is wet. Wetness creates a slippery surface.
- DO NOT leave this item exposed to strong wind and inclement weather.
- When the Slide / Rocker is exposed to direct sunlight, check the temperature on the product surface. If the slide chute is too hot, pour cold water on the slide chute until it cools and wipe dry before giving it to children.
- At the end of each play season or when temperature falls below 32°F / 0°C, remove the product and store indoors. In extreme cold weather, plastic materials lose resilience and may become brittle and crack upon impact.
- Reinstall all plastic parts that were removed for the cold season.
- NEVER attach any materials that are not specifically designed for use with this product, such as (but not limited to) jump ropes, clotheslines, pet leashes, cables and chains, these pose a potential strangulation hazard.
- Discard all packaging properly after unit has been assembled.
- Owners shall be responsible for maintaining the legibility of the warning labels.
- Disassemble and dispose of this product in a safe place and manner, so as not to present any safety hazards to other individuals who may come upon the discarded item.
- Clean the slide regularly with soapy water in order to avoid a build up of static electricity.

LIMITED WARRANTY

Our products are covered under warranty for a period of 1 year* from the date of purchase, under normal use and service, against defective workmanship and material. If you have recently purchased this product and find it to be defective in anyway, kindly return it to the "Source of Purchase" for a Full Refund or Exchange.

Should the product no longer be covered by your Purchase Receipt, or should you have any questions pertaining to our product, please call our Toll Free Customer Service for assistance.

Keep a copy of the UPC Code with proof of purchase receipt for any future Warranty Service.

Please retain packaging and assembly instructions for future reference.

*The warranty period is three (3) months for daycare or commercial purchasers.

©2014 Grow'n Up Limited. All Rights Reserved.

Room 808B, New Mandarin Plaza, Tsim Sha Tsui, Kowloon, Hong Kong.

MADE IN CHINA (SZ)

CUSTOMER SERVICE

USA & Canada: service@grow-n-up.com

Toll free hotline: 1-888-468-9898

Other countries: support@grow-n-up.com

www.grow-n-up.com